

U 4.20

Ersatzteilliste
Spare parts list
Liste de pièces de rechange
Listino pezzi di ricambio
Lista de piezas de recambio
Reserveonderdelenlijst
Reservedelsliste
Reservdelislista

Reservedelsliste
Varaosaluettelo
Wykaz części zamiennych
Seznam náhradních dílů
Tartalékalkatrész lista
Κατάλογος ανταλλακτικών
Yedek parça listesi
Перечень запасных частей
备用零件目录
スペアパーツリスト

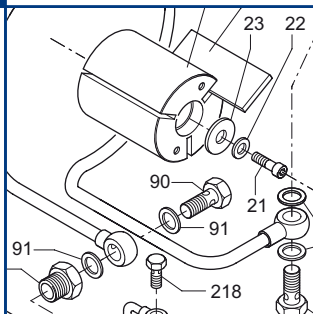

SERVICE

BECKER
D-42279 Wuppertal
www.becker-international.com

year

No. **B**

type **U 4.20-XX**

frequency Hz

speed min⁻¹

power required kW

inlet capacity m³/h

pressure + mbar

vacuum - mbar

Made in Germany

Index Variante

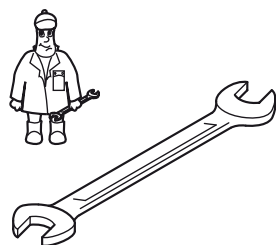

Pos.	Menge ²⁾ Quantity Quantité Quantità Cantidad	Bestell-Nr. Ident No. No. Identification No. Identificazione No. de pedido	Bezeichnung Description Designation Designazione Descripción
□	1	549000 40300	Dichtungssatz, Complete set of seals, Jeu de joints, Kit di guarnizioni, Junta Completa
8	SATZ/KIT	900583 00003	Schieber, Rotor Vane, Palette, Empujador
34	1	965413 00000	Luftentölelement, Oil separating element, Element separation huile, Cartuccia sepa-ratore olio, Elemento de desaceitar de aire

²⁾ erforderliche Bestellmenge / necessary order quantity / quantité nécessaire / quantità di ordinazione necessari / cantidad necesario

Wartung
Maintenance
Entretien
Manutenzione
Mantenimiento



U 4.20

Standard



Variante



U 4.20/XX

- ①
/09
- mit Gasballastventil
 - with gas ballast valve
 - avec l'este d'air
 - con valvola di zavoratrice
 - con valvula de lastre de gas

- ② ③ ④
/53 + /53.1 + /59
- mit Wasserkühler
 - with water radiator
 - avec radiateur d'eau
 - con radiatore d'acqua
 - con radiador de agua

- ⑤
/55
- mit Doppelrückschlagventil
 - with double-check valve
 - avec double valve de retenue
 - con doppia valvola di ritenuta
 - con doble válvula de retención

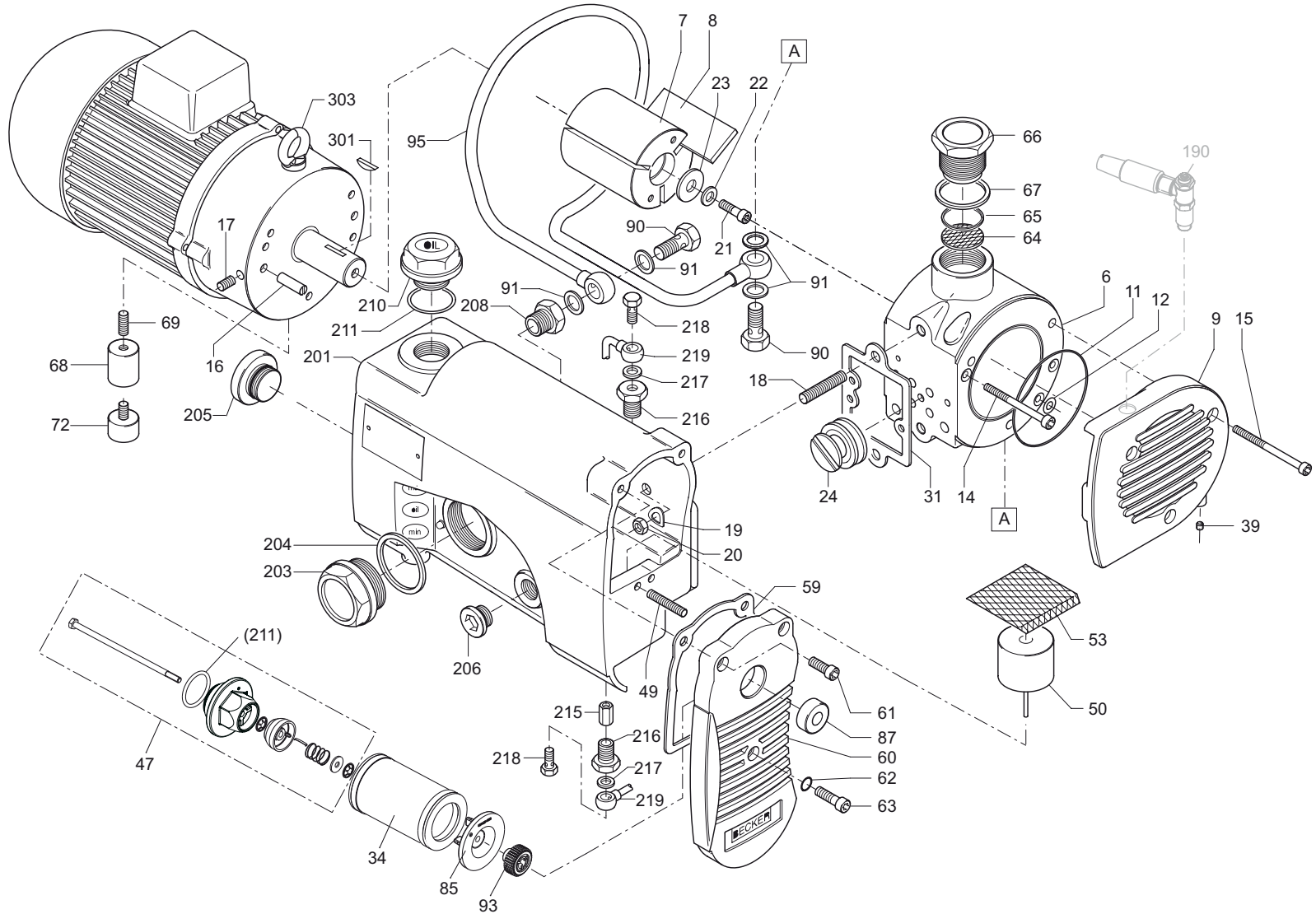

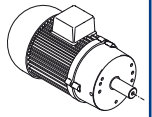

SERVICE ?



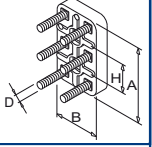
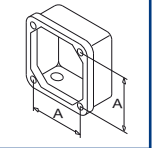
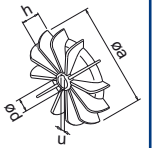
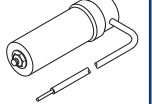

C = ? µF
U = ? V



B INDEX	Pos.	Bestell Nr.	Beschreibung	
U 4.20	□	549000 40300	DICHTUNGSSATZ ¹⁾	
	6	000101 40300	GEHÄUSE	
	7	020001 40300	KOLBEN	
	8	900583 00003	SCHIEBER (SATZ) ²⁾	
	9	000701 40300	SEITENDECKEL	
	11	913117 90000	O-RING	
	12	913161 00000	O-RING	
	14	945371 00000	INNENSECHSKANTSCHRAUBE	
	15	945376 00000	INNENSECHSKANTSCHRAUBE	
	16	947628 00000	ZYLINDERSTIFT	
	17	945805 00000	GEWINDESTIFT	
	18	946917 00000	STIFTSCHRAUBE	
	19	917107 00000	TELLERFEDER	
	20	947105 00000	SECHSKANTMUTTER	
	21	901807 00000	WELLENENDSCHRAUBE	
	22	949203 00000	ZAHNSCHEIBE	
	23	016800 05000	SPANNSCHEIBE	
	24	537500 26200	VENTIL, KOMPL.	
	31	003100 40300	DICHTUNG	
	34	965413 00000	LUFTENTÖLELEMENT (1x) ²⁾	
	39	945618 00000	GEWINDESTIFT	
	47	727504 99628	ABBLASEVENTIL	
	49	945620 00000	GEWINDESTIFT	
	50	867800 99559	SCHWIMMER	
	53	005001 40300	SIEB	
	59	003000 40300	DICHTUNG	
	60	503701 40300	DECKEL	
	61	945319 00000	INNENSECHSKANTSCHRAUBE	
	62	948021 00000	DICHTRING	
	63	945320 00000	INNENSECHSKANTSCHRAUBE	
	64	005000 40300	SIEB	
	65	948227 00000	SEEGER-RING	
	66	537501 18900	RÜCKSCHLAGVENTIL	
	67	948010 00000	ALU-DICHTUNG	
	68	068100 40300	STÜTZE	
69	945623 00000	GEWINDESTIFT		
72	941305 00000	GUMMIPUFFER		
85	016802 40300	SPANNSCHEIBE		
87	953125 00000	DÜSE		
90	948402 00000	HOHLSCHRAUBE		
91	947902 00000	DICHTRING		
93	921500 50000	HANDGRIFF		
95	960206 40300	KÜHLER		
201	002400 40300	ÖLABSCHEIDER		
203	907302 00000	ÖLSCHAUGLAS		
204	91310030100	DICHTUNG		
205	951221 00100	VERSCHLUSS-SCHRAUBE + DICHTUNG		
206	951202 00100	VERSCHLUSS-SCHRAUBE + DICHTUNG		
208	912306 00000	ANSCHLUSSSCHRAUBE		
210	916800 10000	SCHRAUBDECKEL		
211	913116 50100	O-RING		
215	003300 10700	DÜSE		
216	912300 00000	ANSCHLUSSSCHRAUBE		
217	948002 00000	DICHTRING		
218	009400 19000	KUGELSTÜCKSCHRAUBE		
219	012200 40300	LEITUNG		
301	947700 10000	SCHEIBENFEDER		
303	948801 00000	RINGSCHRAUBE		

B INDEX	Pos.	Bestell Nr.	Beschreibung	
		960009 00000 960016 00100 960023 00100	BECKER LUBE M 100 (MINERALÖL) - 1L BECKER LUBE S 100 (SYNTHETIKÖL) - 1L BECKER LUBE SL 100 (LEBENSMITTELBEREICH) - 1L	
¹⁾ Dichtungssatz - 549000 40300 - Pos.: 11, 12, 31, 59, 62, 67, 91, 204, 211, 217				
²⁾ erforderliche Bestellmenge / Wartung				

B INDEX	Pos.	Ident No.	Description	
U 4.20	□	549000 40300	SET OF SEALS ¹⁾	
	6	000101 40300	PUMP BODY	
	7	020001 40300	ROTOR	
	8	900583 00003	VANES (KIT) ²⁾	
	9	000701 40300	LID	
	11	913117 90000	O-RING	
	12	913161 00000	O-RING	
	14	945371 00000	SOCKET HEAD SCREW	
	15	945376 00000	SOCKET HEAD SCREW	
	16	947628 00000	STRAIGHT PIN	
	17	945805 00000	THREADED PIN	
	18	946917 00000	STUD	
	19	917107 00000	SPRING COLLAR	
	20	947105 00000	HEX.NUT	
	21	901807 00000	SCREW	
	22	949203 00000	TOOTHED SPRING WASHER	
	23	016800 05000	CLAMPING DISC	
	24	537500 26200	VALVE	
	31	003100 40300	GASKET	
	34	965413 00000	OIL SEPARATING ELEMENT (1x) ²⁾	
	39	945618 00000	THREADED PIN	
	47	727504 99628	BLOW-OFF VALVE	
	49	945620 00000	THREADED PIN	
	50	867800 99559	FLOAT	
	53	005001 40300	SIEVE	
	59	003000 40300	GASKET	
	60	503701 40300	COVER	
	61	945319 00000	SOCKET HEAD SCREW	
	62	948021 00000	SEALING RING	
	63	945320 00000	SOCKET HEAD SCREW	
	64	005000 40300	SIEVE	
	65	948227 00000	SEEGER-LOCKRING	
	66	537501 18900	NON RETURN VALVE	
	67	948010 00000	SEALING RING	
68	068100 40300	SUPPORT PILLAR		
69	945623 00000	THREADED PIN		
72	941305 00000	RUBBER BUFFER		
85	016802 40300	CLAMPING DISC		
87	953125 00000	NOZZLE		
90	948402 00000	HOLLOW SCREW		
91	947902 00000	SEALING RING		
93	921500 50000	HANDLE		
95	960206 40300	COOLER		
201	002400 40300	HOUSING FOR OIL SEPARATION		
203	907302 00000	OIL SIGHT GLASS		
204	91310030100	GASKET		
205	951221 00100	LOCKING SCREW + GASKET		
206	951202 00100	LOCKING SCREW + GASKET		
208	912306 00000	CONNECTING SCREW		
210	916800 10000	COVER		
211	913116 50100	O-RING		
215	003300 10700	NOZZLE		
216	912300 00000	CONNECTING SCREW		
217	948002 00000	SEALING RING		
218	009400 19000	HOLLOW HOLDING SCREW		
219	012200 40300	PIPE		
301	947700 10000	WOODRUFF KEY		
303	948801 00000	EYE BOLT		

B INDEX	Pos.	Ident No.	Description	
		960009 00000 960016 00100 960023 00100	BECKER LUBE M 100 (MINERAL OIL) - 1L BECKER LUBE S 100 (SYNTHETIC OIL) - 1L BECKER LUBE SL 100 (FOOD SECTOR) - 1L	
¹⁾ Set of seals - 549000 40300 - Pos.: 11, 12, 31, 59, 62, 67, 91, 204, 211, 217				
²⁾ necessary order quantity / maintenance				



B INDICE	Pos.	No. Identification	Designation
U 4.20	□	549000 40300	JEU DE JOINTS ¹⁾
	6	000101 40300	CORP DE POMPE
	7	020001 40300	PISTON
	8	900583 00003	PALETTES (KIT) ²⁾
	9	000701 40300	COUVERCLE
	11	913117 90000	ANNEAU-O
	12	913161 00000	ANNEAU-O
	14	945371 00000	VIS HEXAGONALE INTERNE
	15	945376 00000	VIS HEXAGONALE INTERNE
	16	947628 00000	GOUPILLE CYLINDRIQUE
	17	945805 00000	GOUPILLE FILETEE
	18	946917 00000	PRISONNIER
	19	917107 00000	RONDELLE À RESSORT
	20	947105 00000	ECROU A 6 PANS
	21	901807 00000	VIS
	22	949203 00000	DENT DISQUE
	23	016800 05000	DISQUE DE SERRAGE
	24	537500 26200	SOUPAPE
	31	003100 40300	JOINT
	34	965413 00000	CARTOUCHE SEPARATUER D'HUILE (1x) ²⁾
	39	945618 00000	GOUPILLE FILETEE
	47	727504 99628	SOUPAPE D'ÉCHAPPEMENT
	49	945620 00000	GOUPILLE FILETEE
	50	867800 99559	PIED CAOUTCHOVE
	53	005001 40300	FILTRE
	59	003000 40300	JOINT
	60	503701 40300	COUVERCLE
	61	945319 00000	VIS HEXAGONALE INTERNE
	62	948021 00000	JOINT
	63	945320 00000	VIS HEXAGONALE INTERNE
	64	005000 40300	FILTRE
	65	948227 00000	BAGUE DE SURETE
	66	537501 18900	SOUPAPE ANTI RETOUR
	67	948010 00000	JOINT
	68	068100 40300	SUPPORT INTERMEDIAIRE
	69	945623 00000	GOUPILLE FILETEE
72	941305 00000	AMORTISSEUR EN CAOUTCHOUC	
85	016802 40300	DISQUE DE SERRAGE	
87	953125 00000	GICLEUR	
90	948402 00000	VIS CREUSE	
91	947902 00000	JOINT	
93	921500 50000	POIGNEE	
95	960206 40300	REFROIDISSEUR	
201	002400 40300	CORP DE SEPARATEUR	
203	907302 00000	VERRE REGARD	
204	91310030100	JOINT	
205	951221 00100	BOUCHON + JOINT	
206	951202 00100	BOUCHON + JOINT	
208	912306 00000	VIS DE RACCORD	
210	916800 10000	COUVERCLE	
211	913116 50100	ANNEAU-O	
215	003300 10700	GICLEUR	
216	912300 00000	VIS DE RACCORD	
217	948002 00000	JOINT	
218	009400 19000	VIS CREUSE DE FIXATION	
219	012200 40300	TUYAU	
301	947700 10000	CLAVETTE DEMI-LUNE	
303	948801 00000	ANNEAU À VIS	







B INDICE	Pos.	No. Identification	Designation
		960009 00000 960016 00100 960023 00100	BECKER LUBE M 100 (HUILE MINÉRALE) - 1L BECKER LUBE S 100 (L'HUILE SYNTHÉTIQUE) - 1L BECKER LUBE SL 100 (SECTEUR DE L'ALIMENTATION) - 1L
¹⁾ Jeu de joints - 549000 40300 - Pos.: 11, 12, 31, 59, 62, 67, 91, 204, 211, 217 ²⁾ quantité nécessaire / entretien			

B INDICE	Pos.	No. Identificazione	Designazione
U 4.20	□	549000 40300	SERIE DI GUARNIZIONE ¹⁾
	6	000101 40300	CARCASSA
	7	020001 40300	ROTORE
	8	900583 00003	PALETTE (KIT) ²⁾
	9	000701 40300	COPERCHIO
	11	913117 90000	ANELLO-O
	12	913161 00000	ANELLO-O
	14	945371 00000	VITE ESAGONALE INTERNA
	15	945376 00000	VITE ESAGONALE INTERNA
	16	947628 00000	PERNO
	17	945805 00000	SPINA FILETTATURA
	18	946917 00000	L'ASTA A VITE
	19	917107 00000	RONDELLA A MOLLA
	20	947105 00000	DADO ESAGONALE
	21	901807 00000	VITE
	22	949203 00000	DISCO A DENTE
	23	016800 05000	DISCO DI FISSAGGIO
	24	537500 26200	VALVOLA
	31	003100 40300	GUARNIZIONE
	34	965413 00000	CARTUCCIA SEPARATORE OLIO (1x) ²⁾
	39	945618 00000	SPINA FILETTATURA
	47	727504 99628	VALVOLA DI SCARICO
	49	945620 00000	SPINA FILETTATURA
	50	867800 99559	GALLEGGIANTE
	53	005001 40300	FILTRO
	59	003000 40300	GUARNIZIONE
	60	503701 40300	COPERCHIO
	61	945319 00000	VITE ESAGONALE INTERNA
	62	948021 00000	ANELLO GUARNIZIONE
	63	945320 00000	VITE ESAGONALE INTERNA
	64	005000 40300	FILTRO
	65	948227 00000	ANELLO DI SICUREZZA
	66	537501 18900	VALVOLA NON RITORNO
	67	948010 00000	ANELLO GUARNIZIONE
	68	068100 40300	SUPPORTO
	69	945623 00000	SPINA FILETTATURA
72	941305 00000	AMMORTIZZATORE IN GOMMA	
85	016802 40300	DISCO DI FISSAGGIO	
87	953125 00000	UGELLO	
90	948402 00000	VITE ESAGONALE	
91	947902 00000	ANELLO GUARNIZIONE	
93	921500 50000	MANETTA	
95	960206 40300	RAFFREDDATORE	
201	002400 40300	CARCASSA SEPARATORE OLIO	
203	907302 00000	SPIA LIVELLO OLIO	
204	91310030100	GUARNIZIONE	
205	951221 00100	VITE DI CHIUSURA + GUARNIZIONE	
206	951202 00100	VITE DI CHIUSURA + GUARNIZIONE	
208	912306 00000	ATTACO FILETTATO	
210	916800 10000	COPERCHIO	
211	913116 50100	ANELLO-O	
215	003300 10700	UGELLO	
216	912300 00000	ATTACO FILETTATO	
217	948002 00000	ANELLO GUARNIZIONE	
218	009400 19000	VITE PASSAGGIO OLIO	
219	012200 40300	CONDOTTO	
301	947700 10000	CHIAVETTA MEZZA LUNA	
303	948801 00000	VITE AD ANELLO	

B INDICE	Pos.	No. Identificazione	Designazione
		960009 00000 960016 00100 960023 00100	BECKER LUBE M 100 (OLIO MINERALE) - 1L BECKER LUBE S 100 (OLIO SINTETICO) - 1L BECKER LUBE SL 100 (SETTORE ALIMENTARE) - 1L
¹⁾ Serie di guarnizione - 549000 40300 - Pos.: 11, 12, 31, 59, 62, 67, 91, 204, 211, 217 ²⁾ quantità di ordinazione necessari / manutenzione			

B INDICE	Pos.	No. De pedido	Descripción	
U 4.20	□	549000 40300	JUNTA COMPLETA ¹⁾	
	6	000101 40300	CARCASA	
	7	020001 40300	ÉMBOLO	
	8	900583 00003	EMPUJADOR (KIT) ²⁾	
	9	000701 40300	TAPA LATERAL	
	11	913117 90000	JUNTA TÓRICA	
	12	913161 00000	JUNTA TÓRICA	
	14	945371 00000	TORNILLO HEXAGONAL INTERIOR	
	15	945376 00000	TORNILLO HEXAGONAL INTERIOR	
	16	947628 00000	PASADOR CILÍNDRICO	
	17	945805 00000	VARILLA ROSCADA	
	18	946917 00000	ESPÁRRAGO	
	19	917107 00000	ARANDELA DE APOYO DEL RESORTE	
	20	947105 00000	TUERCA HEXAGONAL	
	21	901807 00000	TORNILLO TERMINAL DE ÁRBOL	
	22	949203 00000	POLEA DENTADA	
	23	016800 05000	ARANDELA TENSORA	
	24	537500 26200	VALVULA COMPLETA	
	31	003100 40300	JUNTA	
	34	965413 00000	ELEMENTO DE DESACEITAR DE AIRE (1x) ²⁾	
	39	945618 00000	VARILLA ROSCADA	
	47	727504 99628	VÁLVULA DE ESCAPE	
	49	945620 00000	VARILLA ROSCADA	
	50	867800 99559	FLOTADOR	
	53	005001 40300	CRIBA	
	59	003000 40300	JUNTA	
	60	503701 40300	TAPA	
	61	945319 00000	TORNILLO HEXAGONAL INTERIOR	
	62	948021 00000	ANILLO DE JUNTA	
	63	945320 00000	TORNILLO HEXAGONAL INTERIOR	
	64	005000 40300	CRIBA	
	65	948227 00000	ANILLO DE RETENCIÓN	
	66	537501 18900	CLAPETA DE RETENCIÓN	
	67	948010 00000	ANILLO DE JUNTA	
68	068100 40300	APOYO		
69	945623 00000	VARILLA ROSCADA		
72	941305 00000	AMORTIGUADOR DE GOMA		
85	016802 40300	ARANDELA TENSORA		
87	953125 00000	TOBERA		
90	948402 00000	TORNILLO HUECO		
91	947902 00000	ANILLO DE JUNTA		
93	921500 50000	EMPUÑADURA		
95	960206 40300	REFRIGERADOR		
201	002400 40300	SEPARADOR DE ACEITE		
203	907302 00000	CRISTAL MIRILLA DE ACEITE		
204	91310030100	JUNTA		
205	951221 00100	TORNILLO DE CIERRE + JUNTA		
206	951202 00100	TORNILLO DE CIERRE + JUNTA		
208	912306 00000	TORNILLO DE EMPALME		
210	916800 10000	TAPA ROSCADA		
211	913116 50100	JUNTA TÓRICA		
215	003300 10700	TOBERA		
216	912300 00000	TORNILLO DE EMPALME		
217	948002 00000	ANILLO DE JUNTA		
218	009400 19000	TORNILLO DE PIEZA ESFÉRICA		
219	012200 40300	CONDUCTO		
301	947700 10000	CHAVETA SEMICIRCULAR		
303	948801 00000	TORNILLO CON ANILLA		

B INDICE	Pos.	No. De pedido	Descripción	
		960009 00000 960016 00100 960023 00100	BECKER LUBE M 100 (ACEITE MINERAL) - 1L BECKER LUBE S 100 (ACEITE SINTÉTICO) - 1L BECKER LUBE SL 100 (SECTOR ALIMENTARIO) - 1L	
¹⁾ Junta completa - 549000 40300 - Pos.: 11, 12, 31, 59, 62, 67, 91, 204, 211, 217 ²⁾ cantidad necesario / mantenimiento				

U 4.20	Variante 	Pos. ²⁾	Bestell Nr. / Ident No. / No. Identification / No. Identificazione / No. De pedido		Beschreibung / Description / Designation / Designazione / Desripcion
			  	  	
① /09 - mit Gasballastventil - with gas ballast valve - avec l'este d'air - con valvola di zavoratrice - con valvula de lastre de gas		9	000702 40300	000701 40300	SEITENDECKEL / LID / COUVERCLE / COPERCHIO / TAPA LATERAL
		190	768717 99626		GASBALLASTVENTIL, KOMPLETT / GAS BALLAST VALVE / L'ESTE D'AIR / VALVOLA DI ZAVORATRICE / VÁLVULA DE LASTRE DE GAS
② /53 - mit Wasserkühler - with water radiator - avec radiateur d'eau - con radiatore d'acqua - con radiador de agua		95	960205 40300	960206 40300	KÜHLER / COOLER / REFROIDISSEUR / RAFFREDDATORE / REFRIGERADOR
		143	012201 40300		LEITUNG / PIPE / TUYAU / CONDOTTO / CONDUCTO
		144	012202 40300		LEITUNG / PIPE / TUYAU / CONDOTTO / CONDUCTO
		146	948402 00000		HOHLSCHRAUBE / HOLLOW SCREW / VIS CREUSE / VITE ESAGONALE / TORNILLO HUECO
		147	948030 00000		DICHTRING / GASKET / JOINT / GUARNIZIONE / JUNTA
③ /53.1		66	537513 99633	537501 99633	RÜCKSCHLAGVENTIL / NON-RETURN-VALVE / SOUPAPE ANTI-RETOUR / VALVOLA NON RITORNO / VÁLVULA ANTIRRETORNO
		95	960205 40300	960206 40300	KÜHLER / COOLER / REFROIDISSEUR / RAFFREDDATORE / REFRIGERADOR
		143	012201 40300		LEITUNG / PIPE / TUYAU / CONDOTTO / CONDUCTO
		144	012202 40300		LEITUNG / PIPE / TUYAU / CONDOTTO / CONDUCTO
		146	948402 00000		HOHLSCHRAUBE / HOLLOW SCREW / VIS CREUSE / VITE ESAGONALE / TORNILLO HUECO
④ /59		66	537511 99633	537501 99633	RÜCKSCHLAGVENTIL / NON-RETURN-VALVE / SOUPAPE ANTI-RETOUR / VALVOLA NON RITORNO / VÁLVULA ANTIRRETORNO
		95	960205 40300	960201 40300	KÜHLER / COOLER / REFROIDISSEUR / RAFFREDDATORE / REFRIGERADOR
		126	969439 00000		ANSCHLUSS / CONNECTION / CONNEXION / CONNESSIONE / CONEXIÓN
		143	012201 40300		LEITUNG / PIPE / TUYAU / CONDOTTO / CONDUCTO
		144	012202 40300		LEITUNG / PIPE / TUYAU / CONDOTTO / CONDUCTO
		146	948402 00000		HOHLSCHRAUBE / HOLLOW SCREW / VIS CREUSE / VITE ESAGONALE / TORNILLO HUECO
⑤ /55 - mit Doppelrückschlagventil - with double-check valve - avec double valve de retenue - con doppia valvola di ritenuta - con doble válvula de retención		66	537512 99633	537501 99633	RÜCKSCHLAGVENTIL / NON-RETURN-VALVE / SOUPAPE ANTI-RETOUR / VALVOLA NON RITORNO / VÁLVULA ANTIRRETORNO

²⁾ variantenabhängige Bauteile / variant-dependent components / composants variante-dependantes / componenti variante-dispendenti / componentes variante-dependientes