

DT/VT 4.2  
DT/VT 4.4  
DT/VT 4.8

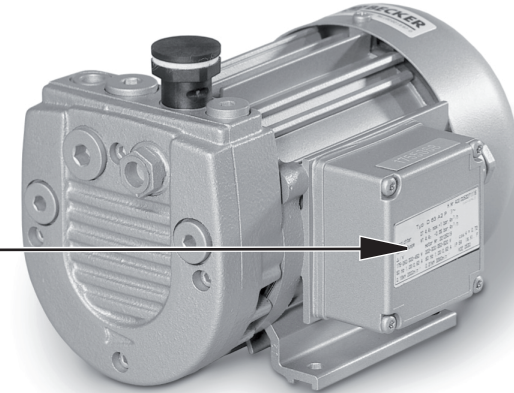
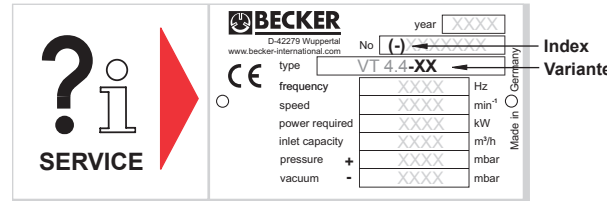
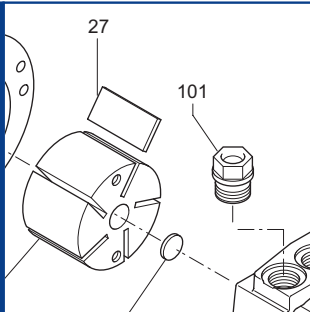

Ersatzteilliste  
Spare parts list  
Liste de pièces de rechange  
Listino pezzi di ricambio  
Lista de piezas de recambio  
Lista de peças sobresselentes  
Reserveonderdelenlijst  
Atsarginių dalių sąrašas  
Varuosad nimekirja  
Rezerves daļu saraksts

Reservedelsliste  
Reservdelslista  
Varaosuettelo  
Reservedelsliste  
Wykaz części zamiennych  
Tartalékalkatrész lista  
Seznam náhradních dílů  
Seznam nadomestnih delov  
Zoznam náhradných dielov  
Rezervni dijelovi popis

Lista pieselor de schimb  
Páirteanna spártha liosta  
Κατάλογος ανταλλακτικών  
Yedek parça listesi  
Списък на резервните части  
Перечень запасных частей  
スベアパーツリスト  
예비 부품 목록  
备用零件目录

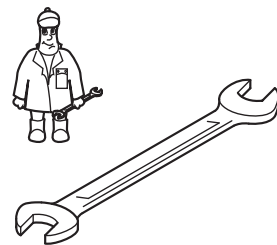

Wartung  
Maintenance  
Entretien  
Manutenzione  
Mantenimiento

| Pos.                           | Menge <sup>1)</sup><br>Quantity<br>Quantité<br>Quantità<br>Cantidad | Bestell-Nr.<br>Ident No.<br>No. Identification<br>No. Identificazione<br>No. de pedido | Bezeichnung<br>Description<br>Designation<br>Designazione<br>Descripción                   |
|--------------------------------|---|--|--|
| <b>DT/VT 4.2<br/>DT/VT 4.4</b> |   |  |  |
| 27                             | SATZ/KIT  | 901387 00005   | Schieber, Rotor Vane, Palette, Empujador   |
| 29                             | 1   | 909580 00000   | Filterpatrone, Filter cartridge, Cartouche Filtrante, Cartuccia filtro, Cartucho de filtro |
| <b>DT/VT 4.8</b>               |   |  |  |
| 27                             | SATZ/KIT  | 901388 00005   | Schieber, Rotor Vane, Palette, Empujador   |
| 29                             | 1   | 909581 00000   | Filterpatrone, Filter cartridge, Cartouche Filtrante, Cartuccia filtro, Cartucho de filtro |

<sup>1)</sup> erforderliche Bestellmenge / necessary order quantity / quantité nécessaire / quantità di ordinazione necessari / cantidad necesario

DT 4.2  
 DT 4.4  
 DT 4.8

Standard



Variante

 DT 4.2/XX  
 DT 4.4/XX  
 DT 4.8/XX

- ② /0-28
- mit Handgriff
  - with handle
  - avec poignée
  - con manetta
  - con empuñadura

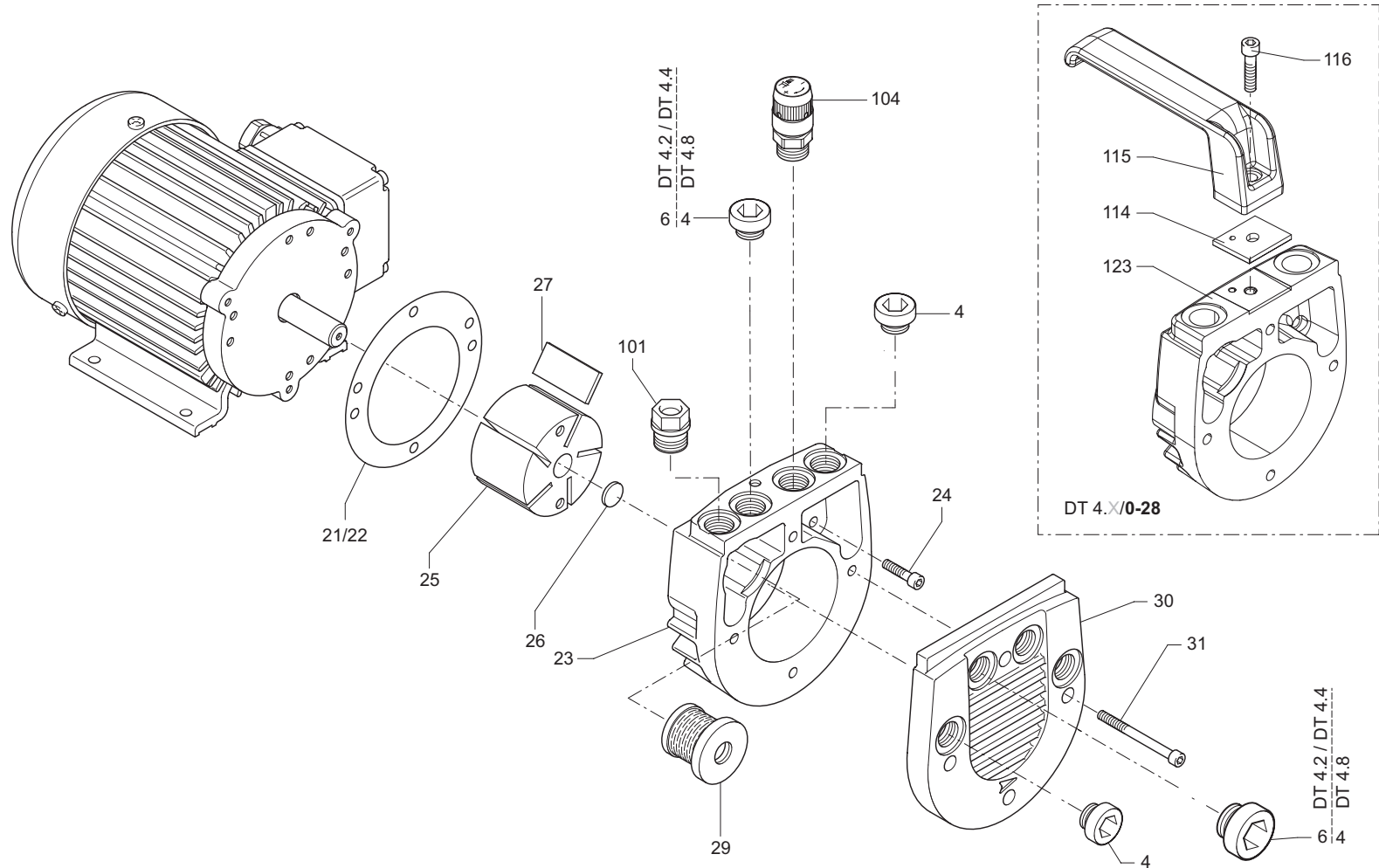

SERVICE ?

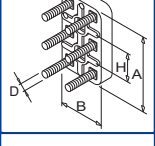
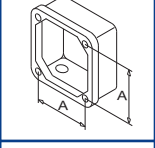
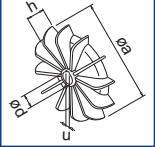
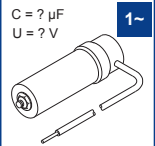
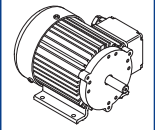

VT 4.2  
 VT 4.4  
 VT 4.8

Standard



Variante



 VT 4.2/XX  
 VT 4.4/XX  
 VT 4.8/XX

- ① /0-05
- Korrosionsschutz
  - corrosion protection
  - protection contre la corrosion
  - protezione anti-corrosione
  - protección contra la corrosión

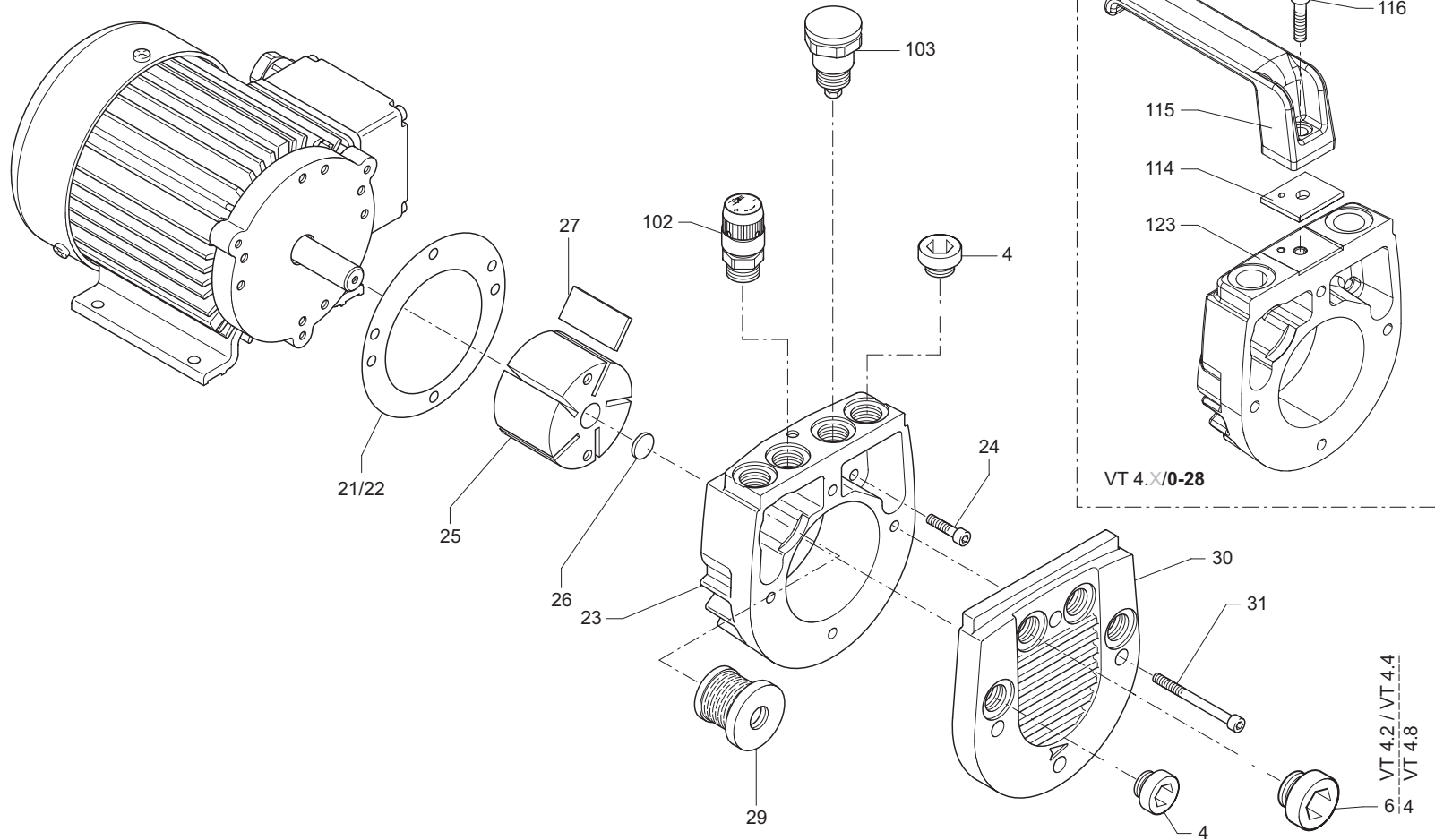
- ② /0-28
- mit Handgriff
  - with handle
  - avec poignée
  - con manetta
  - con empuñadura



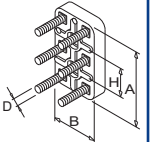
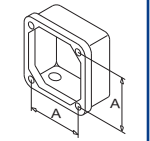
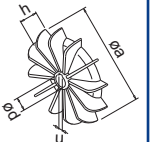
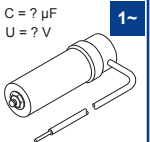
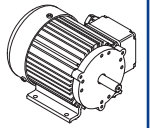

SERVICE ?



 VT 4.2 / VT 4.4  
 VT 4.8

| INDEX  | Pos. | Bestell Nr.  | Beschreibung                            |  |
|--|------|--------------|---|---|
| <b>DT 4.2 / DT 4.4</b>                             | 4    | 951228 02000 | VERSCHLUSS-SCHRAUBE G 1/4"              |   |
|  | 6    | 951228 00000 | VERSCHLUSS-SCHRAUBE G 3/8"              |   |
|  | 21   | 903247 00000 | DICHTUNG 0,127mm                        |   |
|  | 22   | 903248 00000 | DICHTUNG, VIOLETT 0,254mm               |   |
|  | 23   | 000100 27100 | GEHÄUSE                                 |   |
|  | 24   | 945307 00000 | INNENSECHSKANTSCHRAUBE                  |   |
|  | 25   | 020000 27100 | KOLBEN                                  |   |
|  | 26   | 960600 03000 | RONDE                                   |   |
|  | 27   | 901387 00005 | <b>SCHIEBER-KOHL</b> E (SATZ)           |   |
|  | 29   | 909580 00000 | <b>FILTERPATRONE</b> (1x) <sup>1)</sup> |   |
|  | 30   | 000700 27100 | SEITENDECKEL                            |   |
|  | 31   | 945312 00000 | INNENSECHSKANTSCHRAUBE                  |   |
|  | 101  | 943138 00000 | SCHALLDÄMPFERDÜSE                       |   |
|  | 104  | 728000 99687 | DRUCKREGULIERVENTIL                     |   |
| <sup>1)</sup> erforderliche Bestellmenge / Wartung |      |              |   |   |

| INDEX  | Pos. | Bestell Nr.  | Beschreibung                            |  |
|--|------|--------------|---|--|
| <b>VT 4.2 / VT 4.4</b>                             | 4    | 951228 02000 | VERSCHLUSS-SCHRAUBE G 1/4"              |  |
|  | 6    | 951228 00000 | VERSCHLUSS-SCHRAUBE G 3/8"              |  |
|  | 21   | 903247 00000 | DICHTUNG 0,127mm                        |  |
|  | 22   | 903248 00000 | DICHTUNG, VIOLETT 0,254mm               |  |
|  | 23   | 000100 27100 | GEHÄUSE                                 |  |
|  | 24   | 945307 00000 | INNENSECHSKANTSCHRAUBE                  |  |
|  | 25   | 020000 27100 | KOLBEN                                  |  |
|  | 26   | 960600 03000 | RONDE                                   |  |
|  | 27   | 901387 00005 | <b>SCHIEBER-KOHL</b> E (SATZ)           |  |
|  | 29   | 909580 00000 | <b>FILTERPATRONE</b> (1x) <sup>1)</sup> |  |
|  | 30   | 000700 27100 | SEITENDECKEL                            |  |
|  | 31   | 945312 00000 | INNENSECHSKANTSCHRAUBE                  |  |
|  | 102  | 736000 99688 | VAKUUMREGULIERVENTIL                    |  |
|  | 103  | 727500 99689 | ABBLASEVENTIL                           |  |
| <sup>1)</sup> erforderliche Bestellmenge / Wartung |      |              |   |  |

| INDEX         | Pos.   | Bestell Nr.  | Beschreibung                            |  |
|---------------|--|--------------|---|--|
| <b>DT 4.8</b> | 4  | 951228 00000 | VERSCHLUSS-SCHRAUBE G 3/8"              |  |
|               | 21   | 903250 00000 | DICHTUNG 0,127mm                        |  |
|               | 22   | 903249 00000 | DICHTUNG, VIOLETT 0,254mm               |  |
|               | 23   | 000100 27200 | GEHÄUSE                                 |  |
|               | 24   | 945308 00000 | INNENSECHSKANTSCHRAUBE                  |  |
|               | 25   | 020000 27200 | KOLBEN                                  |  |
|               | 26   | 960600 09000 | RONDE                                   |  |
|               | 27   | 901388 00005 | <b>SCHIEBER-KOHL</b> E (SATZ)           |  |
|               | 29   | 909581 00000 | <b>FILTERPATRONE</b> (1x) <sup>1)</sup> |  |
|               | 30   | 000700 27200 | SEITENDECKEL                            |  |
|               | 31   | 945314 00000 | INNENSECHSKANTSCHRAUBE                  |  |
|               | 101  | 943139 00000 | SCHALLDÄMPFERDÜSE                       |  |
|               | 104  | 728000 99687 | DRUCKREGULIERVENTIL                     |  |
|               | <sup>1)</sup> erforderliche Bestellmenge / Wartung |              |   |  |

| INDEX         | Pos.   | Bestell Nr.  | Beschreibung                            |  |
|---------------|--|--------------|---|---|
| <b>VT 4.8</b> | 4  | 951228 00000 | VERSCHLUSS-SCHRAUBE G 3/8"              |   |
|               | 21   | 903250 00000 | DICHTUNG 0,127mm                        |   |
|               | 22   | 903249 00000 | DICHTUNG, VIOLETT 0,254mm               |   |
|               | 23   | 000100 27200 | GEHÄUSE                                 |   |
|               | 24   | 945308 00000 | INNENSECHSKANTSCHRAUBE                  |   |
|               | 25   | 020000 27200 | KOLBEN                                  |   |
|               | 26   | 960600 09000 | RONDE                                   |   |
|               | 27   | 901388 00005 | <b>SCHIEBER-KOHL</b> E (SATZ)           |   |
|               | 29   | 909581 00000 | <b>FILTERPATRONE</b> (1x) <sup>1)</sup> |   |
|               | 30   | 000700 27200 | SEITENDECKEL                            |   |
|               | 31   | 945314 00000 | INNENSECHSKANTSCHRAUBE                  |   |
|               | 102  | 736000 99688 | VAKUUMREGULIERVENTIL                    |   |
|               | 103  | 727500 99689 | ABBLASEVENTIL                           |   |
|               | <sup>1)</sup> erforderliche Bestellmenge / Wartung |              |   |   |

| INDEX  | Pos. | Ident No.    | Description                                |  |
|--|------|--------------|--|---|
| DT 4.2 / DT 4.4                                      | 4    | 951228 02000 | LOCKING SCREW G 1/4"                       |   |
|  | 6    | 951228 00000 | LOCKING SCREW G 3/8"                       |   |
|  | 21   | 903247 00000 | GASKET 0,127mm                             |   |
|  | 22   | 903248 00000 | GASKET, VIOLET 0,254mm                     |   |
|  | 23   | 000100 27100 | PUMP-BODY                                  |   |
|  | 24   | 945307 00000 | SOCKET HEAD SCREW                          |   |
|  | 25   | 020000 27100 | ROTOR                                      |   |
|  | 26   | 960600 03000 | FILLING PIECE                              |   |
|  | 27   | 901387 00005 | <b>CARBON VANES (KIT)</b>                  |   |
|  | 29   | 909580 00000 | <b>FILTER CARTRIDGE (1x) <sup>1)</sup></b> |   |
|  | 30   | 000700 27100 | LID  |   |
|  | 31   | 945312 00000 | SOCKET HEAD SCREW                          |   |
|  | 101  | 943138 00000 | NOZZLE                                     |   |
|  | 104  | 728000 99687 | PRESSURE REGULATING VALVE                  |   |
| <sup>1)</sup> necessary order quantity / maintenance |      |              |  |   |

| INDEX  | Pos. | Ident No.    | Description                                |  |
|--|------|--------------|--|--|
| VT 4.2 / VT 4.4                                      | 4    | 951228 02000 | LOCKING SCREW G 1/4"                       |  |
|  | 6    | 951228 00000 | LOCKING SCREW G 3/8"                       |  |
|  | 21   | 903247 00000 | GASKET 0,127mm                             |  |
|  | 22   | 903248 00000 | GASKET, VIOLET 0,254mm                     |  |
|  | 23   | 000100 27100 | PUMP-BODY                                  |  |
|  | 24   | 945307 00000 | SOCKET HEAD SCREW                          |  |
|  | 25   | 020000 27100 | ROTOR                                      |  |
|  | 26   | 960600 03000 | FILLING PIECE                              |  |
|  | 27   | 901387 00005 | <b>CARBON VANES (KIT)</b>                  |  |
|  | 29   | 909580 00000 | <b>FILTER CARTRIDGE (1x) <sup>1)</sup></b> |  |
|  | 30   | 000700 27100 | LID  |  |
|  | 31   | 945312 00000 | SOCKET HEAD SCREW                          |  |
|  | 102  | 736000 99688 | VACUUM REGULATING VALVE                    |  |
|  | 103  | 727500 99689 | BLOW-OFF VALVE                             |  |
| <sup>1)</sup> necessary order quantity / maintenance |      |              |  |  |

| INDEX  | Pos.   | Ident No.    | Description                                |  |
|--------|--|--------------|--|--|
| DT 4.8 | 4  | 951228 00000 | LOCKING SCREW G 3/8"                       |  |
|        | 21   | 903250 00000 | GASKET 0,127mm                             |  |
|        | 22   | 903249 00000 | GASKET, VIOLET 0,254mm                     |  |
|        | 23   | 000100 27200 | PUMP-BODY                                  |  |
|        | 24   | 945308 00000 | SOCKET HEAD SCREW                          |  |
|        | 25   | 020000 27200 | ROTOR                                      |  |
|        | 26   | 960600 09000 | FILLING PIECE                              |  |
|        | 27   | 901388 00005 | <b>CARBON VANES (KIT)</b>                  |  |
|        | 29   | 909581 00000 | <b>FILTER CARTRIDGE (1x) <sup>1)</sup></b> |  |
|        | 30   | 000700 27200 | LID  |  |
|        | 31   | 945314 00000 | SOCKET HEAD SCREW                          |  |
|        | 101  | 943139 00000 | SILENCING NOZZLE                           |  |
|        | 104  | 728000 99687 | PRESSURE REGULATING VALVE                  |  |
|        | <sup>1)</sup> necessary order quantity / maintenance |              |  |  |

| INDEX  | Pos.   | Ident No.    | Description                                |  |
|--------|--|--------------|--|---|
| VT 4.8 | 4  | 951228 00000 | LOCKING SCREW G 3/8"                       |   |
|        | 21   | 903250 00000 | GASKET 0,127mm                             |   |
|        | 22   | 903249 00000 | GASKET, VIOLET 0,254mm                     |   |
|        | 23   | 000100 27200 | PUMP-BODY                                  |   |
|        | 24   | 945308 00000 | SOCKET HEAD SCREW                          |   |
|        | 25   | 020000 27200 | ROTOR                                      |   |
|        | 26   | 960600 09000 | FILLING PIECE                              |   |
|        | 27   | 901388 00005 | <b>CARBON VANES (KIT)</b>                  |   |
|        | 29   | 909581 00000 | <b>FILTER CARTRIDGE (1x) <sup>1)</sup></b> |   |
|        | 30   | 000700 27200 | LID  |   |
|        | 31   | 945314 00000 | SOCKET HEAD SCREW                          |   |
|        | 102  | 736000 99688 | VACUUM REGULATING VALVE                    |   |
|        | 103  | 727500 99689 | BLOW-OFF VALVE                             |   |
|        | <sup>1)</sup> necessary order quantity / maintenance |              |  |   |

| INDICE          | Pos. | No. Identification | Designation                            |
|-----------------|------|--------------------|--|
| DT 4.2 / DT 4.4 | 4    | 951228 02000       | BOUCHON G 1/4"                         |
|                 | 6    | 951228 00000       | BOUCHON G 3/8"                         |
|                 | 21   | 903247 00000       | JOINT 0,127mm                          |
|                 | 22   | 903248 00000       | JOINT, VIOLET 0,254mm                  |
|                 | 23   | 000100 27100       | CORP DE POMPE                          |
|                 | 24   | 945307 00000       | VIS HEXAGONALE INTERNE                 |
|                 | 25   | 020000 27100       | PISTON                                 |
|                 | 26   | 960600 03000       | ROND EN FEUTRE                         |
|                 | 27   | 901387 00005       | PALETTE DE CHARBON (KIT)               |
|                 | 29   | 909580 00000       | CARTOUCHE FILTRANTE (1x) <sup>1)</sup> |
|                 | 30   | 000700 27100       | COUVERCLE                              |
|                 | 31   | 945312 00000       | VIS HEXAGONALE INTERNE                 |
|                 | 101  | 943138 00000       | GICLEUR                                |
|                 | 104  | 728000 99687       | SOUPAPE REGLAGE PRESSION               |

<sup>1)</sup> quantité nécessaire / entretien

| INDICE          | Pos. | No. Identification | Designation                            |
|-----------------|------|--------------------|--|
| VT 4.2 / VT 4.4 | 4    | 951228 02000       | BOUCHON G 1/4"                         |
|                 | 6    | 951228 00000       | BOUCHON G 3/8"                         |
|                 | 21   | 903247 00000       | JOINT 0,127mm                          |
|                 | 22   | 903248 00000       | JOINT, VIOLET 0,254mm                  |
|                 | 23   | 000100 27100       | CORP DE POMPE                          |
|                 | 24   | 945307 00000       | VIS HEXAGONALE INTERNE                 |
|                 | 25   | 020000 27100       | PISTON                                 |
|                 | 26   | 960600 03000       | ROND EN FEUTRE                         |
|                 | 27   | 901387 00005       | PALETTE DE CHARBON (KIT)               |
|                 | 29   | 909580 00000       | CARTOUCHE FILTRANTE (1x) <sup>1)</sup> |
|                 | 30   | 000700 27100       | COUVERCLE                              |
|                 | 31   | 945312 00000       | VIS HEXAGONALE INTERNE                 |
|                 | 102  | 736000 99688       | SOUPAPE DE REGLAGE VIDE                |
|                 | 103  | 727500 99689       | SILENCIEUX                             |

<sup>1)</sup> quantité nécessaire / entretien

| INDICE | Pos. | No. Identification | Designation                            |
|--------|------|--------------------|--|
| DT 4.8 | 4    | 951228 00000       | BOUCHON G 3/8"                         |
|        | 21   | 903250 00000       | JOINT 0,127mm                          |
|        | 22   | 903249 00000       | JOINT, VIOLET 0,254mm                  |
|        | 23   | 000100 27200       | CORP DE POMPE                          |
|        | 24   | 945308 00000       | VIS HEXAGONALE INTERNE                 |
|        | 25   | 020000 27200       | PISTON                                 |
|        | 26   | 960600 09000       | ROND EN FEUTRE                         |
|        | 27   | 901388 00005       | PALETTE DE CHARBON (KIT)               |
|        | 29   | 909581 00000       | CARTOUCHE FILTRANTE (1x) <sup>1)</sup> |
|        | 30   | 000700 27200       | COUVERCLE                              |
|        | 31   | 945314 00000       | VIS HEXAGONALE INTERNE                 |
|        | 101  | 943139 00000       | GICLEUR                                |
|        | 104  | 728000 99687       | SOUPAPE REGLAGE PRESSION               |

<sup>1)</sup> quantité nécessaire / entretien

| INDICE | Pos. | No. Identification | Designation                            |
|--------|------|--------------------|--|
| VT 4.8 | 4    | 951228 00000       | BOUCHON G 3/8"                         |
|        | 21   | 903250 00000       | JOINT 0,127mm                          |
|        | 22   | 903249 00000       | JOINT, VIOLET 0,254mm                  |
|        | 23   | 000100 27200       | CORP DE POMPE                          |
|        | 24   | 945308 00000       | VIS HEXAGONALE INTERNE                 |
|        | 25   | 020000 27200       | PISTON                                 |
|        | 26   | 960600 09000       | ROND EN FEUTRE                         |
|        | 27   | 901388 00005       | PALETTE DE CHARBON (KIT)               |
|        | 29   | 909581 00000       | CARTOUCHE FILTRANTE (1x) <sup>1)</sup> |
|        | 30   | 000700 27200       | COUVERCLE                              |
|        | 31   | 945314 00000       | VIS HEXAGONALE INTERNE                 |
|        | 102  | 736000 99688       | SOUPAPE DE REGLAGE VIDE                |
|        | 103  | 727500 99689       | SILENCIEUX                             |

<sup>1)</sup> quantité nécessaire / entretien

| INDICE          | Pos. | No. Identificazione | Designazione                        |
|-----------------|------|---------------------|-------------------------------------|
| DT 4.2 / DT 4.4 | 4    | 951228 02000        | VITE DI CHIUSURA G 1/4"             |
|                 | 6    | 951228 00000        | VITE DI CHIUSURA G 3/8"             |
|                 | 21   | 903247 00000        | GUARNIZIONE 0,127mm                 |
|                 | 22   | 903248 00000        | GUARNIZIONE, VIOLA 0,254mm          |
|                 | 23   | 000100 27100        | CARCASSA                            |
|                 | 24   | 945307 00000        | VITE ESAGONALE INTERNA              |
|                 | 25   | 020000 27100        | ROTORE                              |
|                 | 26   | 960600 03000        | SVILUPPO CIRCOLARE IN FELTRO        |
|                 | 27   | 901387 00005        | PALETTE DI CHARBONE (KIT)           |
|                 | 29   | 909580 00000        | CARTUCCIA FILTRO (1x) <sup>1)</sup> |
|                 | 30   | 000700 27100        | COPERCHIO                           |
|                 | 31   | 945312 00000        | VITE ESAGONALE INTERNA              |
|                 | 101  | 943138 00000        | UGELLO                              |
|                 | 104  | 728000 99687        | VALVOLA REGOLAZIONE PRESSIONE       |

<sup>1)</sup> quantità di ordinazione necessari / manutenzione

| INDICE          | Pos. | No. Identificazione | Designazione                        |
|-----------------|------|---------------------|-------------------------------------|
| VT 4.2 / VT 4.4 | 4    | 951228 02000        | VITE DI CHIUSURA G 1/4"             |
|                 | 6    | 951228 00000        | VITE DI CHIUSURA G 3/8"             |
|                 | 21   | 903247 00000        | GUARNIZIONE 0,127mm                 |
|                 | 22   | 903248 00000        | GUARNIZIONE, VIOLA 0,254mm          |
|                 | 23   | 000100 27100        | CARCASSA                            |
|                 | 24   | 945307 00000        | VITE ESAGONALE INTERNA              |
|                 | 25   | 020000 27100        | ROTORE                              |
|                 | 26   | 960600 03000        | SVILUPPO CIRCOLARE IN FELTRO        |
|                 | 27   | 901387 00005        | PALETTE DI CHARBONE (KIT)           |
|                 | 29   | 909580 00000        | CARTUCCIA FILTRO (1x) <sup>1)</sup> |
|                 | 30   | 000700 27100        | COPERCHIO                           |
|                 | 31   | 945312 00000        | VITE ESAGONALE INTERNA              |
|                 | 102  | 736000 99688        | VALVOLA REGOLARE VUOTO              |
|                 | 103  | 727500 99689        | SILENZIATORE                        |

<sup>1)</sup> quantità di ordinazione necessari / manutenzione

| INDICE | Pos. | No. Identificazione | Designazione                        |
|--------|------|---------------------|-------------------------------------|
| DT 4.8 | 4    | 951228 00000        | VITE DI CHIUSURA G 3/8"             |
|        | 21   | 903250 00000        | GUARNIZIONE 0,127mm                 |
|        | 22   | 903249 00000        | GUARNIZIONE, VIOLA 0,254mm          |
|        | 23   | 000100 27200        | CARCASSA                            |
|        | 24   | 945308 00000        | VITE ESAGONALE INTERNA              |
|        | 25   | 020000 27200        | ROTORE                              |
|        | 26   | 960600 09000        | SVILUPPO CIRCOLARE IN FELTRO        |
|        | 27   | 901388 00005        | PALETTE DI CHARBONE (KIT)           |
|        | 29   | 909581 00000        | CARTUCCIA FILTRO (1x) <sup>1)</sup> |
|        | 30   | 000700 27200        | COPERCHIO                           |
|        | 31   | 945314 00000        | VITE ESAGONALE INTERNA              |
|        | 101  | 943139 00000        | UGELLO                              |
|        | 104  | 728000 99687        | VALVOLA REGOLAZIONE PRESSIONE       |

<sup>1)</sup> quantità di ordinazione necessari / manutenzione

| INDICE | Pos. | No. Identificazione | Designazione                        |
|--------|------|---------------------|-------------------------------------|
| VT 4.8 | 4    | 951228 00000        | VITE DI CHIUSURA G 3/8"             |
|        | 21   | 903250 00000        | GUARNIZIONE 0,127mm                 |
|        | 22   | 903249 00000        | GUARNIZIONE, VIOLA 0,254mm          |
|        | 23   | 000100 27200        | CARCASSA                            |
|        | 24   | 945308 00000        | VITE ESAGONALE INTERNA              |
|        | 25   | 020000 27200        | ROTORE                              |
|        | 26   | 960600 09000        | SVILUPPO CIRCOLARE IN FELTRO        |
|        | 27   | 901388 00005        | PALETTE DI CHARBONE (KIT)           |
|        | 29   | 909581 00000        | CARTUCCIA FILTRO (1x) <sup>1)</sup> |
|        | 30   | 000700 27200        | COPERCHIO                           |
|        | 31   | 945314 00000        | VITE ESAGONALE INTERNA              |
|        | 102  | 736000 99688        | VALVOLA REGOLARE VUOTO              |
|        | 103  | 727500 99689        | SILENZIATORE                        |

<sup>1)</sup> quantità di ordinazione necessari / manutenzione





| ÍNDICE   | Pos.         | No. De pedido                 | Descripción                           |  |
|--|--------------|-------------------------------|---------------------------------------|---|
| DT 4.2 / DT 4.4                                  | 4            | 951228 02000                  | TORNILLO DE CIERRE G 1/4"             |   |
|  | 6            | 951228 00000                  | TORNILLO DE CIERRE G 3/8"             |   |
|  | 21           | 903247 00000                  | JUNTA 0,127mm                         |   |
|  | 22           | 903248 00000                  | JUNTA, VIOLETA 0,254mm                |   |
|  | 23           | 000100 27100                  | CARCASA                               |   |
|  | 24           | 945307 00000                  | TORNILLO HEXAGONAL INTERIOR           |   |
|  | 25           | 020000 27100                  | EMBOLO                                |   |
|  | 26           | 960600 03000                  | RODAJA                                |   |
|  | 27           | 901387 00005                  | EMPUJADOR DE CARBÓN (KIT)             |   |
|  | 29           | 909580 00000                  | CARTUCHO DE FILTRO (1x) <sup>1)</sup> |   |
|  | 30           | 000700 27100                  | TAPA LATERAL                          |   |
|  | 31           | 945312 00000                  | TORNILLO HEXAGONAL INTERIOR           |   |
|  | 101          | 943138 00000                  | TOBERA                                |   |
| 104  | 728000 99687 | VÁLVULA REGULADORA DE PRESIÓN |                                       |   |
| <sup>1)</sup> cantidad necesario / mantenimiento |              |                               |                                       |   |

| ÍNDICE   | Pos.         | No. De pedido      | Descripción                           |  |
|--|--------------|--------------------|---------------------------------------|--|
| VT 4.2 / VT 4.4                                  | 4            | 951228 02000       | TORNILLO DE CIERRE G 1/4"             |  |
|  | 6            | 951228 00000       | TORNILLO DE CIERRE G 3/8"             |  |
|  | 21           | 903247 00000       | JUNTA 0,127mm                         |  |
|  | 22           | 903248 00000       | JUNTA, VIOLETA 0,254mm                |  |
|  | 23           | 000100 27100       | CARCASA                               |  |
|  | 24           | 945307 00000       | TORNILLO HEXAGONAL INTERIOR           |  |
|  | 25           | 020000 27100       | EMBOLO                                |  |
|  | 26           | 960600 03000       | RODAJA                                |  |
|  | 27           | 901387 00005       | EMPUJADOR DE CARBÓN (KIT)             |  |
|  | 29           | 909580 00000       | CARTUCHO DE FILTRO (1x) <sup>1)</sup> |  |
|  | 30           | 000700 27100       | TAPA LATERAL                          |  |
|  | 31           | 945312 00000       | TORNILLO HEXAGONAL INTERIOR           |  |
|  | 102          | 736000 99688       | VÁLVULA REGULADORA DE VACÍO           |  |
| 103  | 727500 99689 | VÁLVULA DE BARRIDO |                                       |  |
| <sup>1)</sup> cantidad necesario / mantenimiento |              |                    |                                       |  |

| ÍNDICE   | Pos. | No. De pedido | Descripción                           |  |
|--|------|---------------|---------------------------------------|--|
| DT 4.8   | 4    | 951228 00000  | TORNILLO DE CIERRE G 3/8"             |  |
|  | 21   | 903250 00000  | JUNTA 0,127mm                         |  |
|  | 22   | 903249 00000  | JUNTA, VIOLETA 0,254mm                |  |
|  | 23   | 000100 27200  | CARCASA                               |  |
|  | 24   | 945308 00000  | TORNILLO HEXAGONAL INTERIOR           |  |
|  | 25   | 020000 27200  | EMBOLO                                |  |
|  | 26   | 960600 09000  | RODAJA                                |  |
|  | 27   | 901388 00005  | EMPUJADOR DE CARBÓN (KIT)             |  |
|  | 29   | 909581 00000  | CARTUCHO DE FILTRO (1x) <sup>1)</sup> |  |
|  | 30   | 000700 27200  | TAPA LATERAL                          |  |
|  | 31   | 945314 00000  | TORNILLO HEXAGONAL INTERIOR           |  |
|  | 101  | 943139 00000  | TOBERA                                |  |
|  | 104  | 728000 99687  | VÁLVULA REGULADORA DE PRESIÓN         |  |
| <sup>1)</sup> cantidad necesario / mantenimiento |      |               |                                       |  |

| ÍNDICE   | Pos. | No. De pedido | Descripción                           |  |
|--|------|---------------|---------------------------------------|---|
| VT 4.8   | 4    | 951228 00000  | TORNILLO DE CIERRE G 3/8"             |   |
|  | 21   | 903250 00000  | JUNTA 0,127mm                         |   |
|  | 22   | 903249 00000  | JUNTA, VIOLETA 0,254mm                |   |
|  | 23   | 000100 27200  | CARCASA                               |   |
|  | 24   | 945308 00000  | TORNILLO HEXAGONAL INTERIOR           |   |
|  | 25   | 020000 27200  | EMBOLO                                |   |
|  | 26   | 960600 09000  | RODAJA                                |   |
|  | 27   | 901388 00005  | EMPUJADOR DE CARBÓN (KIT)             |   |
|  | 29   | 909581 00000  | CARTUCHO DE FILTRO (1x) <sup>1)</sup> |   |
|  | 30   | 000700 27200  | TAPA LATERAL                          |   |
|  | 31   | 945314 00000  | TORNILLO HEXAGONAL INTERIOR           |   |
|  | 102  | 736000 99688  | VÁLVULA REGULADORA DE VACÍO           |   |
|  | 103  | 727500 99689  | VÁLVULA DE BARRIDO                    |   |
| <sup>1)</sup> cantidad necesario / mantenimiento |      |               |                                       |   |



| DT/VT 4.2<br>DT/VT 4.4<br>DT/VT 4.8   | Variante<br> | Pos. <sup>2)</sup> | Bestell Nr. / Ident No. / No. Identification /<br>No. Identificazione / No. De pedido |  | Beschreibung / Description / Designation / Designazione / Desripcion  |
|---|---|--------------------|---|--|---|
|   |   |                    |      |  |   |
| ① /0-05<br>- Korrosionsschutz<br>- corrosion protection<br>- protection contre la corrosion<br>- protezione anti-corrosione<br>- protección contra la corrosión |   | 25                 | 020001 27100  | <del>020000 27100</del>  | VT 4.2 + VT 4.4 ◀ KOLBEN / ROTOR / PISTON / ROTORE / ÉMBOLO   |
|   |   |                    | 020002 27200  | <del>020000 27200</del>  | VT 4.8 ◀ KOLBEN / ROTOR / PISTON / ROTORE / ÉMBOLO  |
| ② /0-28<br>- mit Handgriff<br>- with handle<br>- avec poignee<br>- con manetta<br>- con empuñadura  |   | 23                 |   | <del>000100 27100</del>  | GEHÄUSE / PUMP BODY / CORP DE POMPE / CARCASSA / CARCASA  |
|   |   | 114                | 008900 15900  |  | DICHTUNG / GASKET / JOINT / GUARNIZIONI / ANILLO  |
|   |   | 115                | 021500 15900  |  | HANDGRIFF / HANDLE / POIGNEE / MANETTA / EMPUÑADURA   |
|   |   | 116                | 945320 00000  |  | INNENSECHSKANTSCHRAUBE / HEX HEAD SCREW / VIS HEXAGONALE INTERNE / VITE ESAGONALE INTERNA / TORNILLO HEXAGONAL INTERIOR |
|   |   | 123                | 000102 27100  |  | GEHÄUSE / PUMP BODY / CORP DE POMPE / CARCASSA / CARCASA  |

<sup>2)</sup> variantenabhängige Bauteile / variant-dependent components / composants variante-dependantes / componenti variante-dispendenti / componentes variante-dependientes